

**MANUAL DAMPERS**

The Model RD is a G-90 galvanized steel damper with factory mounted with heavy duty locking hand quadrant designed especially for manual balancing applications. It is easy to install, seal, and becomes part of the duct work.



**MODEL RD**

approx. 1/8" (3.1mm) o.d. undersized

DIAMETER	LENGTH	BODY & BLADE
4 - 10" (102 - 254mm)	8" (203mm)	20 ga.
12 - 18" (305 - 457mm)	8" (203mm)	20 ga.
20 - 30" (508 - 762mm)	8" (203mm)	20 ga.
32 - 40" (813 - 1016mm)	8" (203mm)	18 ga.

**SHAFT:**

- 3/8" (9.5mm) square steel axle pins (thru 16" (406mm))
- 1/2" (12.7mm) round solid aluminum (18"(457mm) thru 30"(762mm))
- 3/4" (19mm) round solid steel (32"(813mm) thru 40"(1016mm))

**BEARING:**

Molded synthetic  
 Nylon 6/6

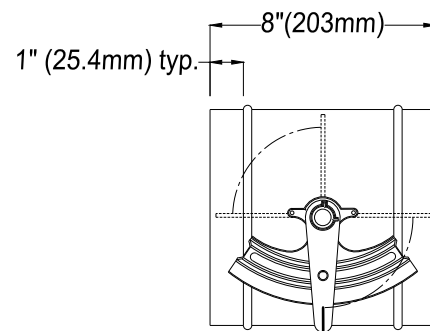

**VARIATIONS:**

- Stainless steel body, blade, shaft and quadrant
- All aluminum (0.063" frame AND blade) construction w/ steel plated quadrant
- Extended quadrant 2" (50.88mm)

MAXIMUM VELOCITY		
DIAMETER	FPM (M/S)	MAX. PRESSURE DIFFERENTIAL Inches w.g. (kpa)
4 - 8" (102 - 203mm)	2600 (13.2)	3" (0.75)
10 - 12" (254 - 305mm)	2400 (12.2)	2-1/2" (0.62)
14 - 18" (356 - 457mm)	2300 (11.7)	2" (0.50)
20 - 24" (508 - 610mm)	2300 (11.7)	1.5" (0.37)
26 - 30" (660 - 762mm)	2200 (11.2)	1.25" (0.31)
32 - 40" (813 - 1016mm)	2000 (10.2)	0.75" (0.19)

Job Name:	<input type="checkbox"/> <b>MODEL RD</b> (see Dwg. B-8 for performance data)		
Location:			
Architect:			
Engineer:	DRAWN BY: CLJ	DATE: 2-16-93	REV. DATE: 4-8-21 VD
Contractor:	REV. NO. 21	APPROVED BY: BGT	DWG. NO.: <b>B-3</b>

## ROUND DAMPERS

### STATIC PRESSURE DROP

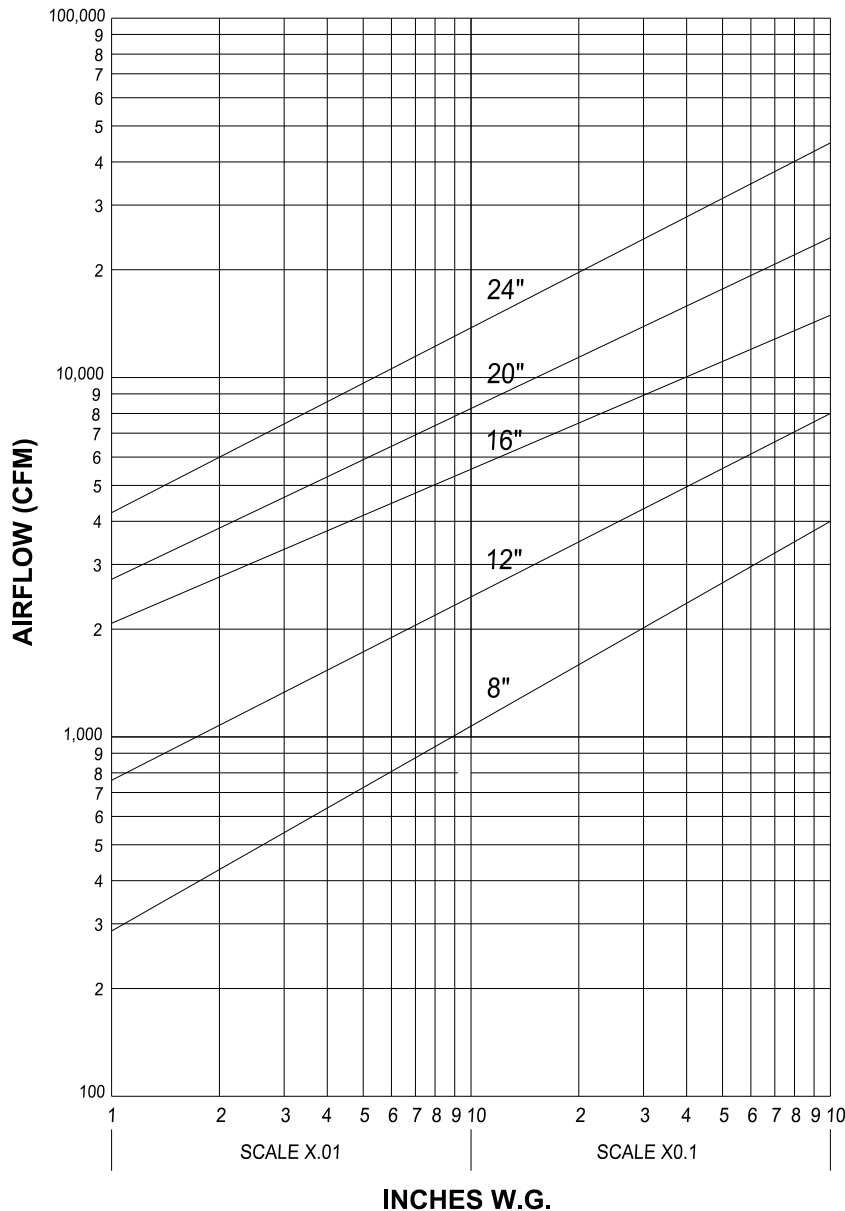

#### Determining Static Pressure Drop (Round)

To determine static pressure drop through an open damper, start on the left side of the damper pressure drop chart. Given the CFM of air flow through the damper, follow the CFM line to the diagonal line of the damper size required, then down to the static pressure drop of the unit.

#### Example:

The pressure drop of an 8" damper with 700 CFM flow is .051 inches w.g.

Job Name:	<input type="checkbox"/> <b style="color: green;">Performance Data</b>		
Location:			
Architect:			
Engineer:	DRAWN BY: CLJ	DATE: 10-11-10	REV. DATE: 4-8-21 VD
Contractor:	REV. NO.	APPROVED BY: BGT	DWG. NO.: <b>B-8</b>