

MODEL BRSED-5.1

BLAST RESISTANT STATIONARY LOUVER

STANDARD CONSTRUCTION:

(welded assembly)

FRAME:

0.081 [2.06mm] Extruded 6063T5 Aluminum 5.1" [129.54mm] Deep

BLADES:

0.081 [2.06mm] Extruded 6063T5 Aluminum on approximately 2.13" [54.1mm] centers.

BLADE BRACES:

Placed 30" [762 mm] max o.c.

SCREEN

0.50" [12.70mm] x 0.050" [1.3mm] Flattened Aluminum in removable frame. Screen is mounted as standard on inside (rear) as looking from exterior of building.

FINISH:

Mill Aluminum (Std)

MINIMUM SIZE:

12"w [304.8mm] x 12"h [304.8mm]

MAXIMUM SIZE:

Factory Assembled 60"w [1524mm] x 120"h [3048mm]

FEATURES

Withstands up to 10.48 psi peak pressure and an impulse of 64 psi-ms.

OPTIONS:

- Insect Screen (Other Screens Available, See Screen Page)
- Filter Racks (no screen)
- Security Bars

AVAILABLE FINISHES:

- Powder Polyester TGIC (2 coats) baked on at 410°F, 2.5 to 3.5 mils Meets AAMA-2603 Standards**
- Powder Super durable polyester (2 coats) baked on at 410°F, 2.5 to 3.5 mils Meets AAMA-2604-05 Standards**
- Acrylic baked enamel (ACRA-BOND® ULTRA) by AkzoNobel baked on at 350°F, 0.8 to 1.2 mils dry Meets AAMA-2603 Standards**
- Kynar® (ALUM*A*STAR®) 2 coats by AkzoNobel baked on at 450°F, 1.2 to 1.6 mils dry Meets AAMA-2604-05 Standards**
- Kynar 500® or HYLAR® 5000 70% TRINAR® (2 coats) by AkzoNobel baked on at 450°F, 1.2 to 1.6 mils dry, Meets AAMA-2605-05 Standards**
- Kynar 500® or HYLAR® 5000 (70% Tri-Escent II) (2 coats) by AkzoNobel, a superior finish to other metallic or anodized finishes. A blend of mica, ceramic, and inorganic pigments creates subtle yet dazzling design that goes beyond metallic color without the requirement of a clear coat. 14 standard colors - custom colors available. Baked on at 415°F, 1.4 to 1.8 mils dry, meets AAMA 2605-05.**
- Clear Anodize 204 R-1 Class II (AA-C22A31)(0.4 to 0.7 mil)**
- Clear Anodize 215 R-1 Class I (AA-C22A41)(>0.7 mil)**
- Integral Color Anodize (AA-C22A42)(>0.7 mil)**
 - Clear coat available for all above finishes.
 - Hylar® 5000 is a registered trademark of Solvay Solexis, Inc.
 - Kynar® 500 is a registered trademark of Arkema.
 - ALUM*A*STAR® 50 and TRINAR® are registered trademarks of AkzoNobel
 - ACRA-BOND® ULTRA is a registered trademark of AkzoNobel

Blast Requirement Examples	
Pressure	Impulse
4 psi	28 psi-ms
6 psi	42 psi-ms
8 psi	59 psi-ms
10 psi	90 psi-ms

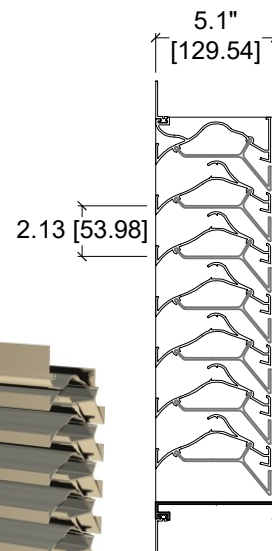

TESTED IN ACCORDANCE WITH
ASTM F 2927-12

DAMAGE RATING: I
(UNDAMAGED)

Minimal Deflection, No breakage

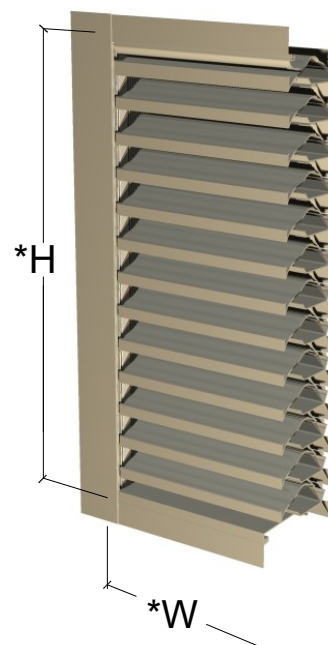

*Width and Height dimensions are approximately 1/4" [6.35mm] under listed size.
(See dwg. no A-19 for water penetration, wind driven rain, pressure drop, and free area data)

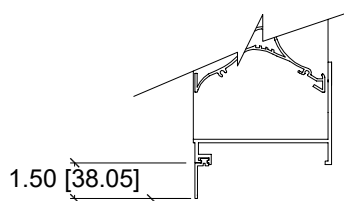

HEAD/SILL DETAIL

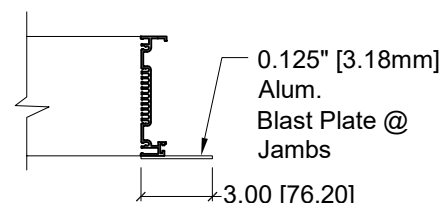

JAMB DETAIL



3005 South Hickory Street
Chattanooga, Tennessee 37407
Tel: (423) 698-7715
Fax: (423) 698-6629
www.unitedenertech.com

MODEL BRSED-5.1 (Multiple-Series Drain Wind Driven Rain Louver)

Due to continuing research, United Enertech reserves the right to change specifications without notice.

DRAWN BY: BMR	DATE: 2-25-13	REV. DATE: 6-4-13	REV. NO. 2	APPROVED BY: CLJ	DWG. NO.: A-19i
------------------	------------------	----------------------	---------------	---------------------	--------------------